



SISKIN ROAD
UPPINGHAM, RUTLAND

JAMES
SELICKS



“... THREE-BEDROOM, SEMI-DETACHED PROPERTY ...”

A well-presented three-bedroom semi-detached property, offering off-road parking and a private rear garden, all within walking distance of Uppingham town centre.

Dining Kitchen • One Reception Room • Downstairs Cloakroom • Three Bedrooms • Family Bathroom, One Ensuite • Off-Road Parking • Private Rear Garden • Walking Distance to Town Centre • EPC - C • NO CHAIN •

Accommodation

The property is entered via a small entrance hall giving access to the ground floor accommodation, which comprises a dining kitchen, a reception room, and a downstairs cloakroom.

The dining kitchen is located to the rear of the property and features a good range of shaker-style units, a variety of integrated appliances, space for white goods, and a French door opening onto the patio and rear garden. The well-proportioned reception room is situated to the front of the property and benefits from a bay window.

A staircase rises from the central hallway to the first-floor landing, which provides access to three bedrooms. The principal bedroom is complemented by an en-suite shower room, while the remaining two bedrooms are served by a family bathroom. The bathroom comprises a shower over bath, wash hand basin, low-flush WC, and a heated towel rail.

Outside

Externally, there is a small lawned area to the front with a planted border and a pathway to the front door. An archway to the left leads to two allocated parking spaces and a pedestrian gate providing access to the rear garden. The rear garden is partially laid to lawn, with a patio directly adjoining the property, mature raised beds, and a useful garden shed.



Location

Uppingham is a picturesque market town in Rutland, known for its rich history, vibrant arts scene, and strong community spirit. Often called "Stamford in miniature," it features honey-hued stone buildings, cobbled streets, and a welcoming atmosphere. The town offers an eclectic mix of boutique shops and restaurants around the Market Square and High Street. Excellent primary and secondary schools serve the area. Conveniently located near the A47, Uppingham provides easy access to Leicester, Peterborough, Corby, and Kettering—all with mainline train services to London in under an hour.

Services & Council Tax

The property is offered to the market with all mains services and gas-fired central heating.

Rutland County Council – Tax Band C

Tenure

Freehold



26 Siskin Road, Uppingham, Oakham, Rutland LE15 9UL

House Total Approx. Gross Internal Floor Area = 800 ft² / 74 m²

Measurements are approximate, not to scale, for illustrative purposes only.

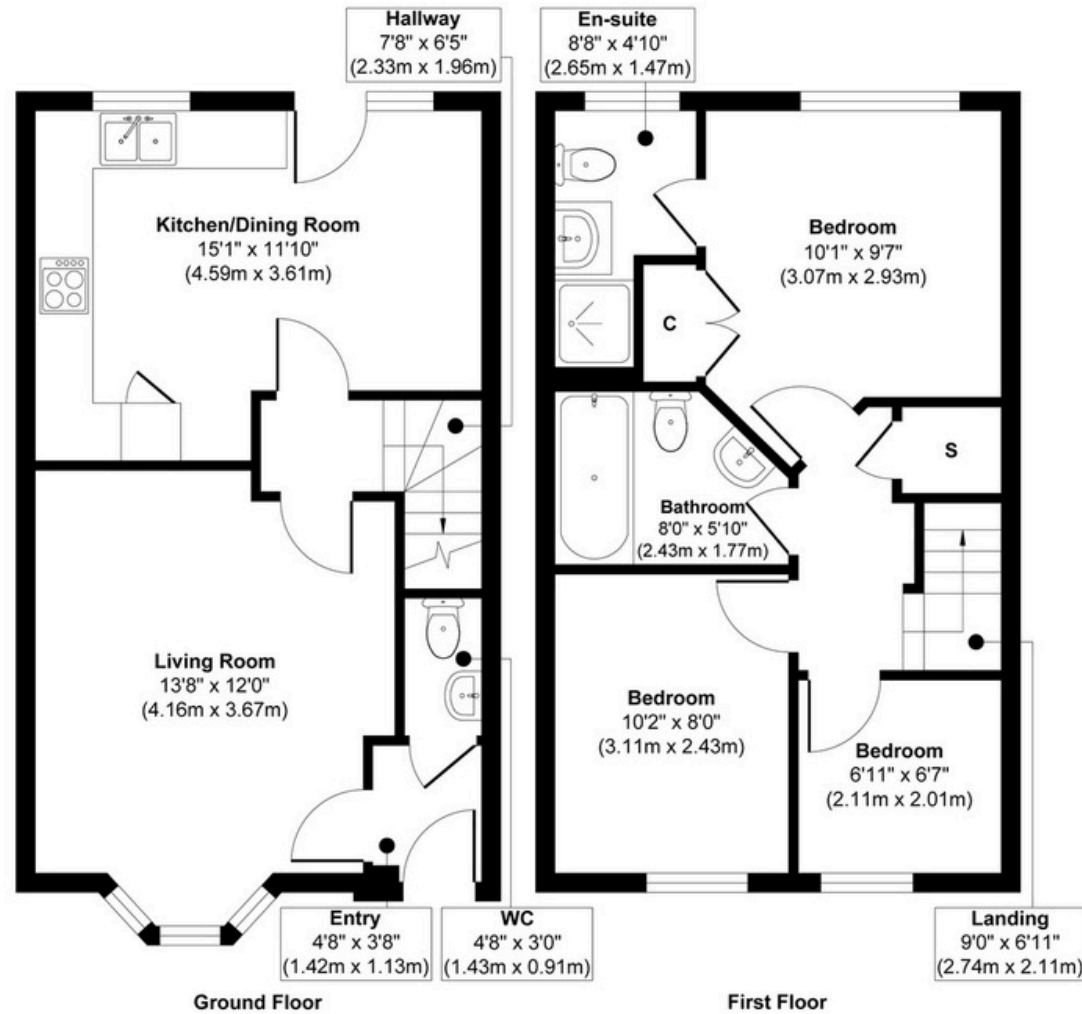



JAMES SELICKS

Oakham Office

6-8 Market Place, Oakham
Rutland LE15 6DT

01572 724 437

oakham@jamesselicks.com

Market Harborough Office

01858 410 008

Leicester Office

0116 285 4554

www.jamesselicks.com



Important Notice

- James Sellicks for themselves and for the Vendors whose agent they are, give notice that:
- 1) The particulars are intended to give a fair and substantially correct overall description for the guidance of intending purchasers and do not constitute part of an offer or contract. Prospective purchaser(s) and lessees ought to seek their own professional advice.
 - 2) All descriptions, dimensions, areas, reference to condition and if necessary, permissions for use and occupation and their details are given in good faith and believed to be correct. Any intending purchaser(s) should not rely on them as statements or representations of fact but must satisfy themselves by inspection or otherwise as to the correctness of each of them.
 - 3) No person in the employment of James Sellicks has any authority to make or give any representation or warranty, whether in relation to this property or these particulars, nor to enter any contract relating to the property on behalf of the Vendors.
 - 4) No responsibility can be accepted for any expenses incurred by any intending purchaser(s) in inspecting properties that have been sold, let, or withdrawn.

Measurements and Other Information

All measurements are approximate. Whilst we endeavour to make our sales particulars accurate and reliable, if there is any point which is of particular importance to you, please contact this office and we will be pleased to check the information for you, particularly if contemplating travelling some distance to view the property.